

Panel/Link® - MAIN BREAKER TRANSFER PANELS - TT Series (cont'd)

TT Series -Type T (26 branch circuits): - Generator-Ready 150 Amp.

**Indoor
Surface/Flush:**
38 lbs
37.25"h x 14.38"w
x 3.94"d

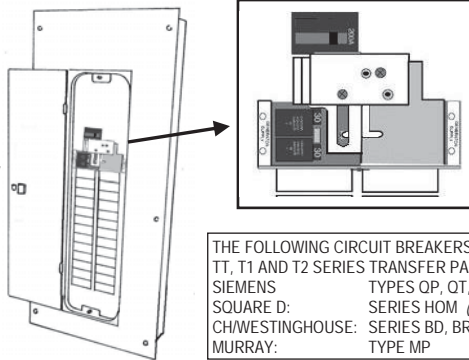

Outdoor (NEMA 3R):
53 lbs
38.25"h x 14.25"w
x 4.5"d

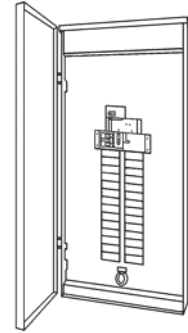

THE FOLLOWING CIRCUIT BREAKERS ARE UL LISTED FOR USE WITH ALL TR TT, T1 AND T2 SERIES TRANSFER PANELS:
SIEMENS: TYPES QP, QT, QPH, HOP, QPF, QPHF, QFP, QE, QEH
SQUARE D: SERIES HOM (100A Maximum)
CH/WESTINGHOUSE: SERIES BD, BR, BQ, GFC (All 100A Maximum)
MURRAY: TYPE MP

Catalog Number		Specifications					
Indoor Surface/Flush	Outdoor (NEMA 3R)	Max. Utility Input Amps	Max. Gen. Input Amps	Gen. Power Inlet-Included	Watt Meters Included	Max. Circuits -Single Pole	Max. Gen. Input - kW
TTT1503C	-	150	30	Optional (See Power Inlet Kits on Page 11)	Yes	26	7.5
TTT1503D	TTT1503DR		30		No		7.5
TTT1505C	-		50	Yes	12.5		
TTT1505D	TTT1505DR		50	No	12.5		
TTT1506C	-		60	Yes	15		
TTT1506D	TTT1506DR		60	No	15		
TTT1510D	TTT1510DR		100	No	25		
TTT1512D	TTT1512DR		125	No	31.25		

TT Series - Type V (36 branch circuits): - Generator-Ready 200 Amp.

**Indoor
Surface/Flush:**
46 lbs
39"h x 14.38"w
x 3.94"d

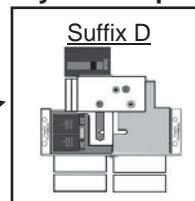
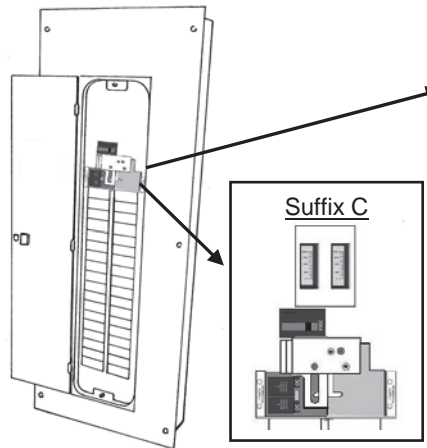

Outdoor (NEMA 3R):
59 lbs
40"h x 14.25"w x 4.5"d

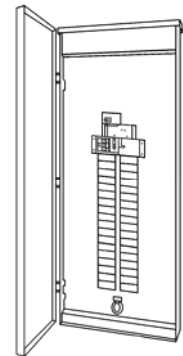

THE FOLLOWING CIRCUIT BREAKERS ARE UL LISTED FOR USE WITH ALL TR TT, T1 AND T2 SERIES TRANSFER PANELS:
SIEMENS: TYPES QP, QT, QPH, HOP, QPF, QPHF, QFP, QE, QEH
SQUARE D: SERIES HOM (100A Maximum)
CH/WESTINGHOUSE: SERIES BD, BR, BQ, GFC (All 100A Maximum)
MURRAY: TYPE MP

Catalog Number		Specifications					
Indoor Surface/Flush	Outdoor (NEMA 3R)	Max. Utility Input Amps	Max. Gen. Input Amps	Gen. Power Inlet-Included	Watt Meters Included	Max. Circuits -Single Pole	Max. Gen. Input - kW
TTV2003C	-	200	30	Optional (See Power Inlet Kits on Page 11)	Yes	36	7.5
TTV2003D	TTV2003DR		30		No		7.5
TTV2005C	-		50	Yes	12.5		
TTV2005D	TTV2005DR		50	No	12.5		
TTV2006C	-		60	Yes	15		
TTV2006D	TTV2006DR		60	No	15		
TTV2010D	TTV2010DR		100	No	25		
TTV2012D	TTV2012DR		125	No	31.25		