

SELECTING GASOLINE

Step 1: Flip the START UP switch to ON.

Step 2: Flip the LOW IDLE switch to OFF.

Step 3: Turn FUEL SOURCE knob (located on the side of the generator) to GAS.

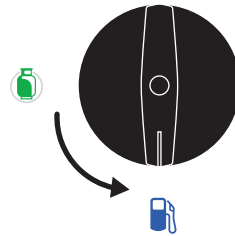
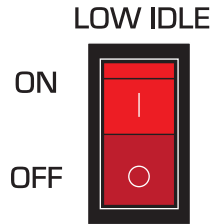
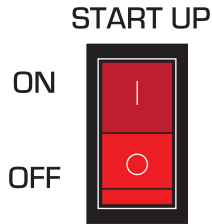

Step 4: Turn the gas valve clockwise to open. (located on the gas cap).

Step 5: Pull CHOKE OUT (located on the side of the generator).

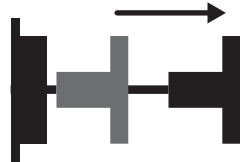
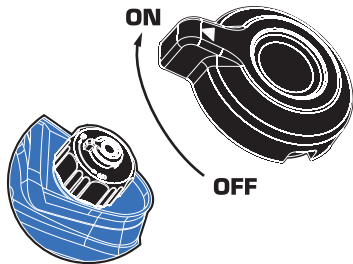

Step 6: Pull the recoil handle. (located on the side of the generator).

Step 7: Push CHOKE IN (located on the side of the generator).

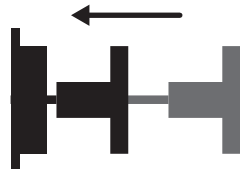

SELECTING PROPANE

Step 1: Flip the START UP switch to ON.

Step 2: Flip the LOW IDLE switch to OFF.

Step 3: Turn FUEL SOURCE knob (located on the side of the generator) to LPG.

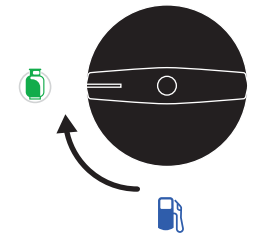
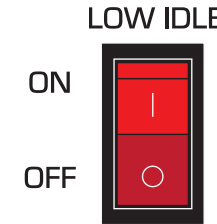
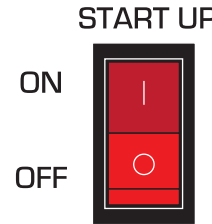

Step 4: Turn the gas valve counter clockwise to closed. (located on the gas cap).

Step 5: Attach the LPG hose to both the generator inlet and the propane tank, then turn the tank on.

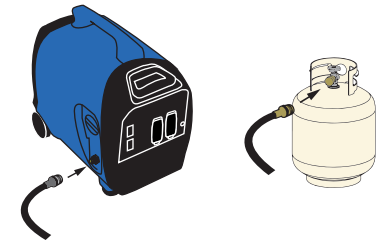
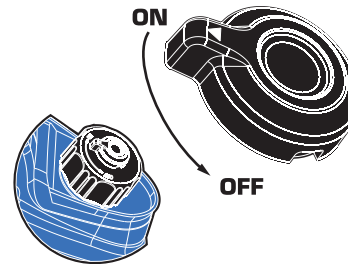

Step 6: Press the decompression valve on the regulator.

Step 7: Pull the recoil handle. (located on the side of the generator).

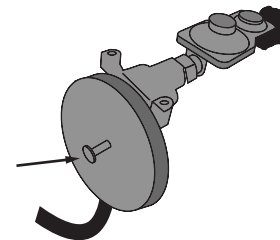

OR