

NOTE: HOSES MAY BE SHOWN WITH BENDS AND ELEVATIONS THAT DO NOT REFLECT OPTIMUM INSTALLATION AND ARE SHOWN FOR ILLUSTRATION PURPOSES ONLY.

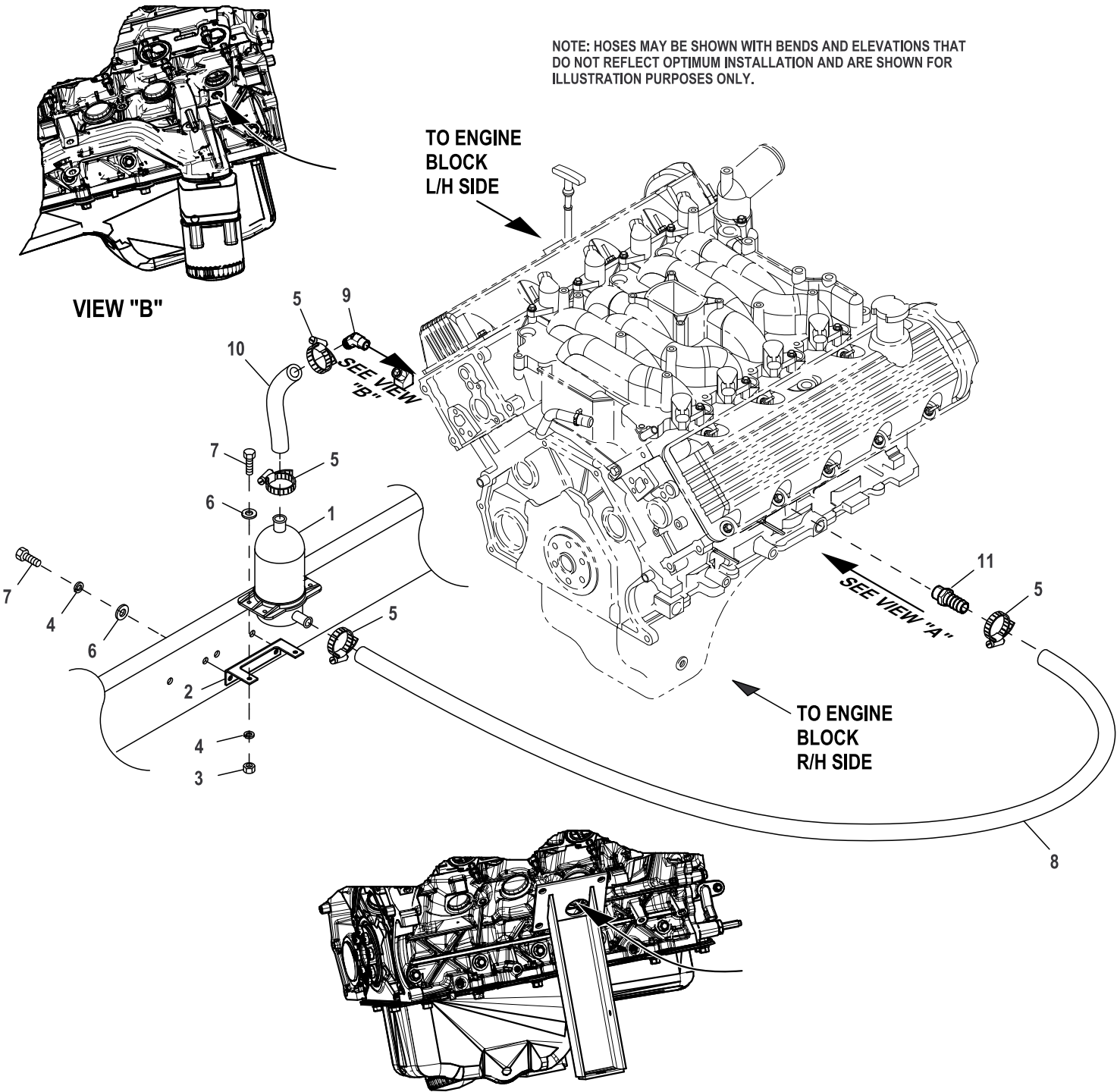

VIEW "B"

**TO ENGINE
BLOCK
L/H SIDE**

**SEE VIEW
"B"**

SEE VIEW "A"

**TO ENGINE
BLOCK
R/H SIDE**

VIEW "A"

EXPLODED VIEW: EV BLOCK HEATER 5.4L CPL KIT

DRAWING #: 0J7373

GROUP H

ITEM	PART#	QTY.	DESCRIPTION
1	084918N	1	HEATER BLOCK 2000W 240V
2	084427	1	BRACKET HEATER W/WELDNUTS
3	049813	2	NUT HEX M6 X 1.0 G8 YEL CHR
4	022097	4	WASHER LOCK M6-1/4
5	057822	4	CLAMP HOSE #8 .53-1.00
6	022473	4	WASHER FLAT 1/4-M6 ZINC
7	042568	4	SCREW HHC M6-1.0 X 20 G8.8
8	050967	1	HOSE COOL 5/8 ID 20R3 (24" LG)
9	0C4905	1	BARBED EL 45 3/8 NPT X 5/8 OD
10	0A6283	1	HOSE PREFORMED BLOCK HEATER
11	044117	1	BARBED STR 3/8NPT X 5/8

Block Heater Installation Instructions 5.4L G3 2000W, 240V Heater

1. Disconnect battery cables to prevent accidental start-up. Disconnect the negative battery cable first from the battery post indicated by (-) or NEG.
2. Assemble block heater (084918N, I/N 1) and bracket (084427, I/N 2) as shown, and attach it to the frame using specified screws (042568, I/N 7) and washers (022097, I/N 4) and (022473, I/N 6).
3. Remove radiator pressure cap. **DANGER:** Do not remove the radiator pressure cap while the engine is hot. Serious burns to skin and eyes from boiling liquid or steam could result.
4. Drain all coolant from radiator into a clean drain pan. Coolant will later be used to refill the radiator.
5. Drain coolant from engine block by removing 3/8" NPT plug from left side of the engine block. Use a funnel and a second clean drain pan. Coolant will later be used to refill the radiator. Replace plug with 3/8" NPT 45 degree barbed fitting (0C4905, I/N 9). Use Teflon pipe sealant on threads to ensure proper thread sealing.
6. Remove 3/8" NPT plug from the right side of the engine block and replace with 3/8" NPT barbed fitting (044117, I/N 11). Use Teflon pipe sealant on threads to ensure proper thread sealing.
7. Install coolant hose (0A6283, I/N 10) to block heater as shown. Connect other end of hose to 3/8" NPT 45 degree barbed fitting (0C4905, I/N 9).
8. Install coolant hose (050967, I/N 8) to block heater as shown. Clamp the other end of the hose shut with a soft jaw clamp. Take care not to damage the hose.
9. Slowly fill the engine with previously drained coolant through the radiator until coolant drips out of the 3/8" NPT barbed fitting (044117, I/N 11).
10. Bleed out air from block heater and hoses by releasing clamp pressure from open end of hose (I/N 8) and holding vertically away from the ground and at the same elevation as the right side fitting (I/N 11). If needed carefully fill the hose with coolant using a funnel. The entire hose should be full of coolant. Connect the hose onto the 3/8" NPT barbed fitting (I/N 11).
Note: Block heater failure will occur if the next steps are not done properly.
11. Check that both block heater hoses (I/N 8 & I/N 10) are routed away from exhaust manifolds.
12. Top off the radiator with coolant.
13. Plug block heater into appropriate 240V power source.
14. Reconnect battery cables to battery posts. Connect the positive cable first to the battery post indicated by (+) or POS.
15. Run engine at least **20 min.** or until coolant temperature stabilizes to get rid of any air pockets in the coolant lines.
16. Check coolant level after engine fully cools down, use caution when removing radiator pressure cap. Coolant should be just below the fill cap neck. Top off if needed.
17. Recheck tightness of all hose connections.
18. Clean up all coolant that may have spilled during the installation of the block heater kit.