

To install the battery/engine heater:

1. Verify a unit that has cooled completely. Turn the latches to lift and remove the roof on the unit. Put the engine start switch in the "OFF" position and remove the 7.5A main fuse from the fuse holder. Disconnect (by using the transfer switch) any AC inputs to the unit.
2. Remove the side panel. Remove the NEGATIVE (-) battery cable first and then the POSITIVE (+) battery cable from the battery. Remove the battery from the unit (Figure 1). Using a clean towel, wipe the bottom of the battery to remove any dirt, oil or contaminants.
3. Place the heater pad under the battery (Figure 2).
4. Place the battery in the unit. Connect the POSITIVE (+) battery cable first and then the NEGATIVE (-) battery cable.
5. Connect the two-pin plug to one of the plug equipped leads on the kit's wiring harness. (Figure 2).
6. Remove the oil drain hose free from retaining clip. Remove the cap from the hose and drain the oil into a suitable container. After the oil has drained, replace the cap onto the end of the oil drain hose. Remove the existing oil filter and replace using the oil filter provided in the kit. Retain the hose in the clip. Locate and remove the socket plug using an 8 mm allen wrench (Figure 4).
7. Carefully thread and install the oil heater into the drain plug hole and tighten with an 11/16" wrench. Refill the crankcase with the correct engine oil; refer to the owner's manual for the correct viscosity and amount.
8. Connect the two-pin plug to the other plug equipped lead on the kit's wiring harness. (Figure 4).
9. Route the wires along frame (Battery side), passing them over the intake boot for the alternator. Pass the wires through the Customer Connect bushing with yellow N1 and N2 wires and bring them to the 240 VAC terminal block (Figure 3).
10. Connect both the leads to the 240 VAC Input Sense terminal block (N1 and N2). Press on top of spring loaded terminal block and insert harness leads. **HEATERS REQUIRE 240 VAC TO OPERATE!**
11. Replace the side panel removed in Step 2. Replace the 7.5A DC fuse and reconnect the AC power supply to the unit. Set the engine start switch to the desired position. Install and secure the roof by turning the latches to the closed position.

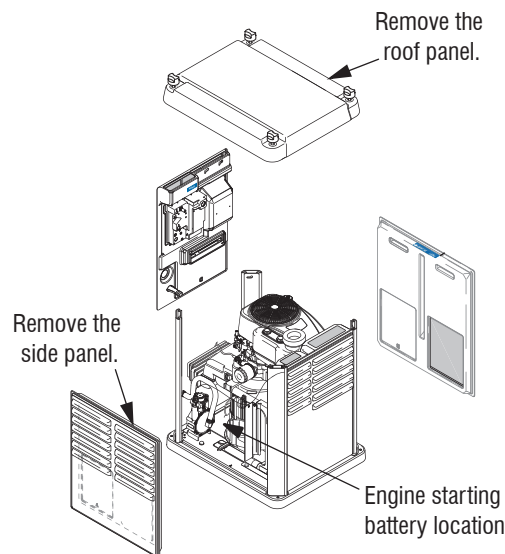

Figure 1

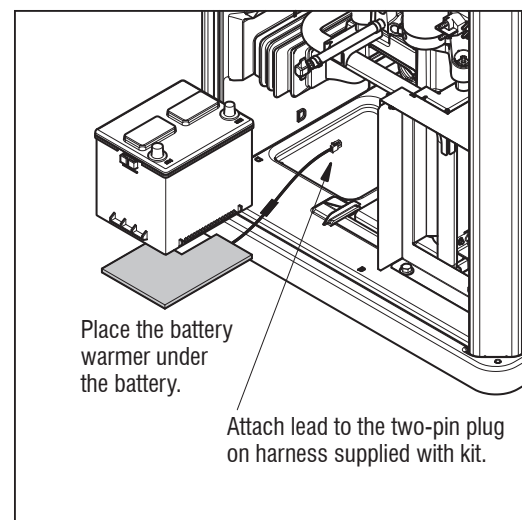

Figure 2

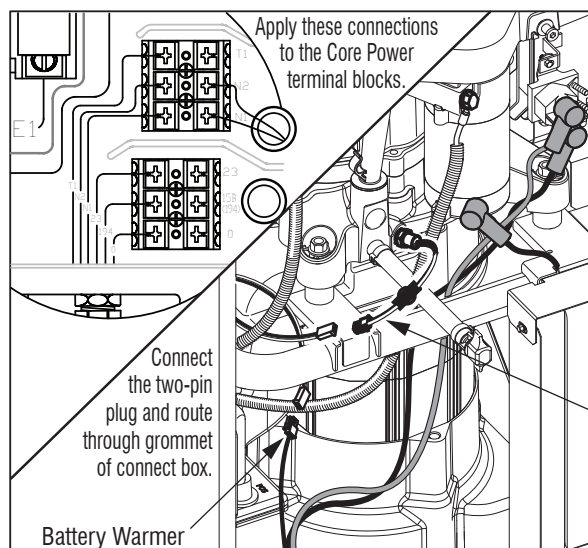

Figure 3

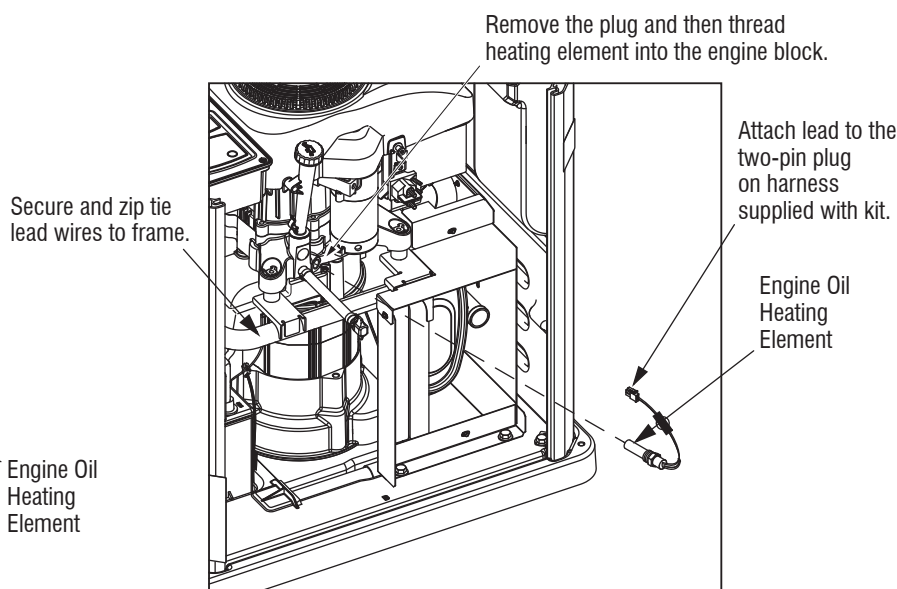

Figure 4